

# AUSTRALASIA



TRIX CIRCUS

## ANCHORAGE PIN RAIL

STRONG

ENGINEERED

SAFE

CERTIFIED

USER GUIDE

# TRIX AERIAL RESCUE AND ANCHORAGE PIN RAIL OVERVIEW

This manual is a guide that should be used alongside the advice and practice of a qualified rigger and structural engineer. All installations should be overseen by a licensed rigger with the relevant circus experience and qualified licensed structural engineer.

At any time, please contact Trix Circus – [info@trixcircus.com](mailto:info@trixcircus.com) – or +61 0466 158 820 with any concerns or questions.

We are always here to support your safety.

## Pin Rail - Working Load Limits (WLL)

MAXIMUM COMBINED 2000kgs WLL

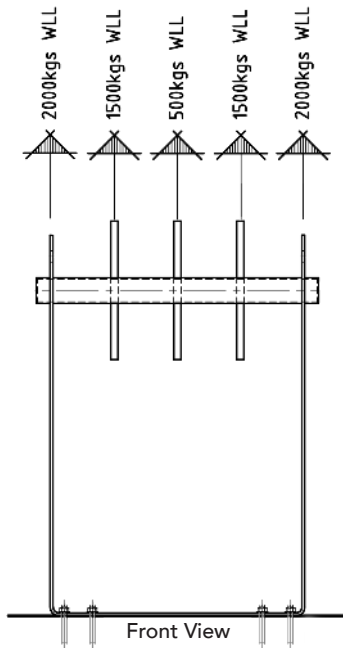

These Working Load Limits should never be exceeded and if they are the unit must be retired immediately.

The Pin Rail is not designed for side loading. The engineering is only valid for direct upwards pulling.

The Pin Rail must only be installed on a suitable thickness and grade concrete slab. Please contact the structural engineer of your building or studio for their requirements.

CAUTION: USE AT OWN RISK  
AERIAL CIRCUS IS INHERENTLY DANGEROUS  
USE UNDER CORRECT SUPERVISION WITH CORRECT INSTALLATION PROCEDURE  
INSPECT BEFORE EVERY USE

[www.TrixCircus.com](http://www.TrixCircus.com) • [Info@TrixCircus.com](mailto:Info@TrixCircus.com)

©2022 Trix Circus Pty LTD. International Patents Pending  
Document Last Modified: January 22, 2023

# USER RISK

*This usage guide is not a substitute for the advice and assistance of a qualified circus rigger and structural engineer. It is merely a guide for experienced and qualified personnel.*

## **General Notes: Risk and Responsibility**

- Aerial circus is dangerous. The risk can be minimized but there always remains the possibility of serious injury or death.
- It is the responsibility of the owner to make sure that a qualified circus rigger and structural engineer oversees the set-up, inspection and operation of the pin rail.
- Only use the equipment if you understand and accept all responsibility for the risks (including personal injury or death) involved.
- Any part of the pin rail or attached systems must be subject to regular inspection. Any part of the pin rail anchor maintains the possibility of failure due to overloading or incorrect usage and other errors. All components of the pin rail should be checked before and after each use for signs of damage or fatigue.
- Every person assisting with set up or use of the pin rail must be familiar with this guide and instructed on proper installation.
- Trix Circus is not responsible for any direct, indirect or accidental consequences or damage stemming from the use of the equipment.
- All components of the pin rail have been engineered specifically for the system by Ken Brown and Associates. No components shall be substituted for any other or altered. Any substitution will void the engineering calculations and the pin rail will no longer be compliant to the engineer's designs. In this case, the responsibility of Trix Circus, Bell-Fab Pty Ltd and Ken Brown and Associates will be voided.

CAUTION: USE AT OWN RISK  
AERIAL CIRCUS IS INHERENTLY DANGEROUS  
USE UNDER CORRECT SUPERVISION WITH CORRECT INSTALLATION PROCEDURE  
INSPECT BEFORE EVERY USE

[www.TrixCircus.com](http://www.TrixCircus.com) • [Info@TrixCircus.com](mailto:Info@TrixCircus.com)

©2022 Trix Circus Pty LTD. International Patents Pending

Document Last Modified: January 22, 2023

# TRIX AERIAL RESCUE AND ANCHORAGE PIN RAIL TYING OFF GUIDE



1. Lay the rope in front of the rail & behind the bottom pin.



2. Begin a figure eight.



3. Complete the figure eight.



4. Make a half hitch.



5. Put the half hitch on the top pin & pull tight.



6. Begin another figure eight.



7. Add another half hitch on the top pin & pull tight.



8. Add a second half hitch on the top pin.



9. Pull tight & make sure your tie off is secure.

CAUTION: USE AT OWN RISK  
AERIAL CIRCUS IS INHERENTLY DANGEROUS  
USE UNDER CORRECT SUPERVISION WITH CORRECT INSTALLATION PROCEDURE  
INSPECT BEFORE EVERY USE

[www.TrixCircus.com](http://www.TrixCircus.com) • [Info@TrixCircus.com](mailto:Info@TrixCircus.com)

©2022 Trix Circus Pty LTD. International Patents Pending

Document Last Modified: January 22, 2023

# GENERAL CONDITIONS AND WAIVER - EQUIPMENT PURCHASE

1. Thank you for using products of Trix Circus Pty Ltd ACN 098 101 547 of 7 Mayes Place, Ormeau Qld 4208 (Us or TC) (Products). We want You to enjoy our Products in good health.
2. TC manufactures circus apparatus and related Products. You should consider some obvious and inherent risks in activities associated with our products (Activities).
3. You, by your Activities, accept the inherent risks of which a prudent person is or should be aware. You should consider this participation an exercise in good judgment and act in a responsible manner.
4. For everyone's safety, you must read and comply with these General Conditions and Waiver at all times, pay careful attention to Trix Circus' Product Information Sheets and carry out your own safety checks before Activities.
5. Activities involve significant exertion, stress and heights. You must be physically and mentally fit, having no medical conditions which could put You, Us or others at risk. Not all our products are suitable for pregnant women, those with heart problems, high blood pressure or back problems for example. You should inform Us and seek medical advice if uncertain.
6. Restrictions (including weight) apply to activities as for workplace health and safety (WHS) reasons. Please report any WHS issues to Us immediately.
7. You must wear suitable clothing and accessories and be aware that Your property may be damaged or dirtied when using Our Products.
8. The venue hosting the Activities must provide You appropriate Personal Protective Equipment (PPE). Please use the PPE according to directions and treat it carefully so it works best for You.
9. Coaches, parents, guardians and carers are responsible for persons under their supervision, such as children.
10. Activities should vary subject to adverse weather conditions, maintenance activity or other operational reasons.
11. No glassware, sharp objects, food, beverages, alcohol or drugs may be associated with Activities except for tap water in a drink bottle.
12. You are responsible for your own property.
13. You must act carefully both for Yourself and others, and refrain from behaviour which could affect your safety, the safety of others, the safety of the Activities.
14. You must not infringe our intellectual property rights including copyright, designs, systems and patents.
15. You agree to the use of Your image and likeness for Our promotion and related purposes without compensation in relation to Products.
16. We take all reasonable steps to provide you with safe and enjoyable Products. However, You and all Users use Our Products at your own risk. You and all Users indemnify us and We are not liable for any person in respect of the loss of life or personal injury to, any person, whether that loss, damage or personal injury is by any person's (including Our) misfeasance and/or non-feasance.
17. We may add special conditions to these terms at our discretion in writing, verbally or by our conduct. This would usually be for WHS or other reasons. You are welcome to offer us special conditions in writing for signed acceptance from Our director.
18. By using and our purchasing Our Products you agree to these terms. If this is not acceptable, We will happily accept return of our Products and refund the purchaser of our products all payments, immediately and in full.

CAUTION: USE AT OWN RISK  
AERIAL CIRCUS IS INHERENTLY DANGEROUS  
USE UNDER CORRECT SUPERVISION WITH CORRECT INSTALLATION PROCEDURE  
INSPECT BEFORE EVERY USE

[www.TrixCircus.com](http://www.TrixCircus.com)

©2021 Trix Circus - International Patents Pending

